

WESTGATE

THE FUTURE IS HERE... AND IT'S QUITE BRIGHT!

INSTALLATION INSTRUCTIONS

LED RETROFIT PANEL KIT

PLEASE read these instructions carefully before installation and keep for reference.

IMPORTANT

READ CAREFULLY BEFORE INSTALLING FIXTURE. RETAIN THESE INSTRUCTIONS FOR FUTURE REFERENCE.

This fixture must be wired in accordance with the National Electrical Code and all applicable local codes. Proper grounding is required for safety. THIS PRODUCT MUST BE INSTALLED IN ACCORDANCE WITH THE APPLICABLE INSTALLATION CODE BY A PERSON FAMILIAR WITH THE CONSTRUCTION AND OPERATION OF THE PRODUCT AND THE HAZARDS INVOLVED.

WARNING: Make certain power is OFF before installing or maintaining fixture. No user serviceable parts inside.

WARNING: Risk of fire or electric shock. Luminaire wiring and electrical parts may be damaged when drilling for installation of LED retrofit kit. Check for enclosed wiring and components.

WARNING - Risk of fire or electric shock. Install this kit only in luminaires that have the construction features and dimensions shown in the photographs and/or drawings .

WARNING - To prevent wiring damage or abrasion, do not expose wiring to edges of sheet metal or other sharp objects.

WARNING – Risk of fire or electric shock. LED Retrofit Kit installation requires knowledge of luminaires electrical systems. If not qualified, do not attempt installation. Contact a qualified electrician.

Only those open holes indicated in the drawings may be made or altered as a result of kit installation. Do not leave any other open holes in an enclosure of wiring or electrical components.

Do not make or alter any open holes in an enclosure of wiring or electrical components during kit installation.

This retrofit kit is accepted as a component of a luminaire where the suitability of the combination shall be determined by authorities having jurisdiction.

Suitable for damp locations.

RECESSED CEILING MOUNTING

Remove the accessories from the original housing

(ballast, fluorescent tube, sockets, brackets, and other accessories that may interfere with the installation).

Note: The original housing must remain in place. Set aside the input wires (line and neutral) of original housing so they can be connected to the retrofit kit in a later step. Plug previous holes from the ballast with appropriate screws and wire nuts.

- 1、 Insert both brackets into the panel edges between the housing and the grid. secure the brackets to the fixture using the provided #8x5/8" self-drilling screws. There are two hole sets to allow for clearing fixture features that may obstruct the screws. **(Fig.1)**
- 2、 Insert both side bars into the panel edges between the brackets and the T-grid. **(Fig.2)**
- 3、 Insert the rotary screws on the edge of the panel into the bracket chutes. Push to the end in the direction of the chutes to secure panel. Attach the safety cables from the retrofit kit to the brackets. **(Fig.3)**
- 4、 Connect the line and neutral wires from the original housing to the driver of the retrofit using appropriate connectors (see above diagram for wire identification). If using 0-10V dimmer, connect DIM+ & DIM- to 0-10V dimmer wires coming from the driver. Ensure the fixture is grounded by connecting the green ground wire of the retrofit kit to the green wire of the original housing with a wiring cap. **(Fig.4)**
- 5、 Secure the door assembly body by lock the latches riveted on each end of the assembled door frame. **(Fig.5)**
- 6、 Installation completed. **(Fig.6)**

INSTALLATION INSTRUCTIONS

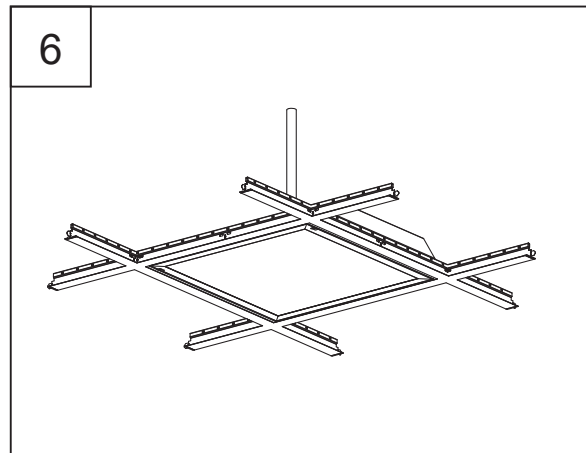
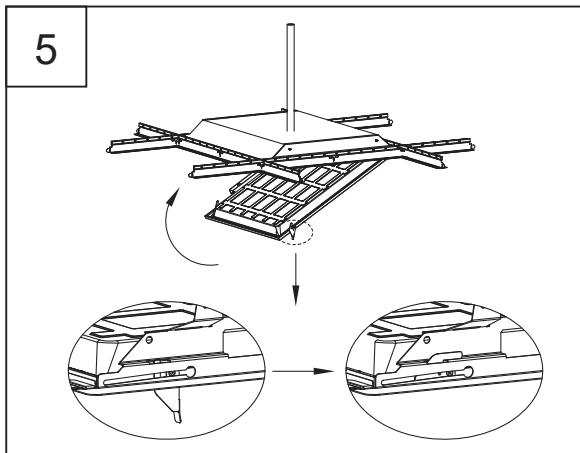
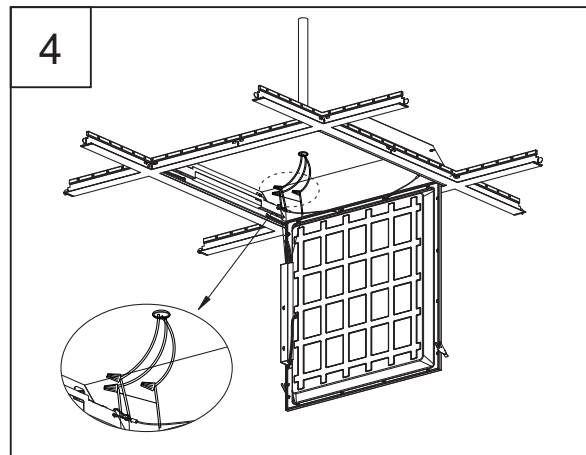
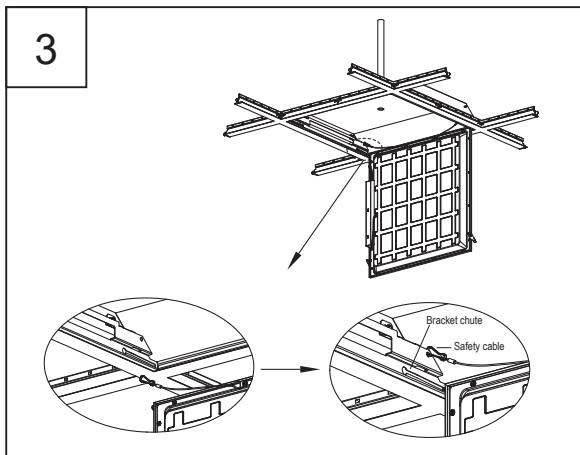
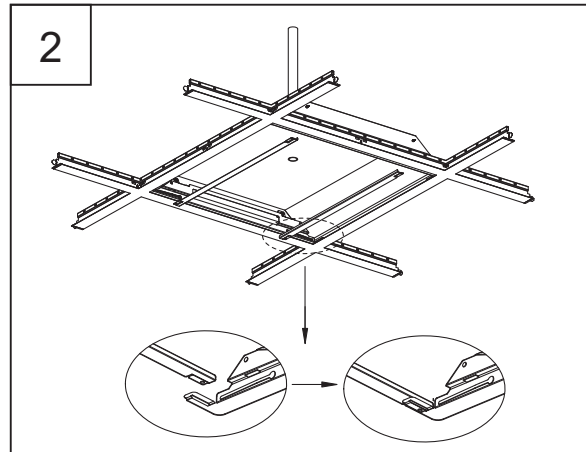
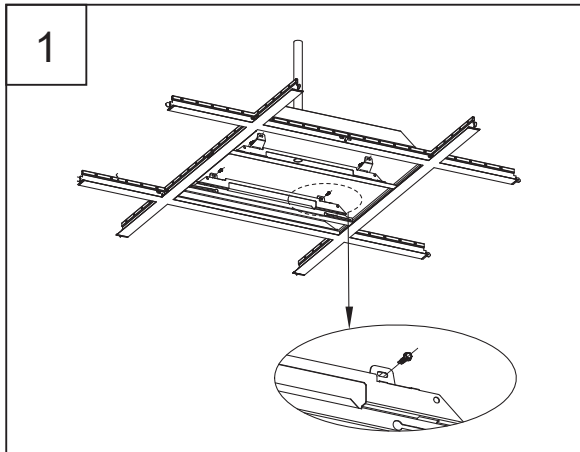

General Wiring Diagram

CAUTION: Turn off electrical power at fuse or circuit breaker box before wiring fixture to the power supply.

Connecting panels to AC source supply:
All units must be individually connected to the AC supply.

Operating characteristic:
Voltage input: 120/277V 50/60 Hz
Operating temp: -40°F to 104°F

TO SOURCE
120V-277V

BLACK (LINE)

WHITE (NEUTRAL)

GREEN (GROUND)

LED Driver

PURPLE

PINK

DIM (+)
(DIMMING WIRES TO 0-10V
IEC COMPLIANT CONTROL.)

DIM (-)

YELLOW WHITE RED
(-) (-) (+)
(LEAD WIRES
TO LED LOAD)